



Horse Dental Equipment
H.D.E.



USER MANUAL

H.D.E. FLEXXIDISC curved or straight
H.D.E. POLYFLOAT

Horse Dental Equipment H.D.E.
Quality Made in France
www.Horse-Dental-Equipment.com

© 2010

Please read carefully before using the H.D.E. instruments

- HDE dentistry equipment is designed for equine use only.
- Although easy to handle the instrument must be used by qualified and horse experienced persons only
- Always inform your client of possible adverse effects of dental procedures.
- Use with full mouth speculum only



Flexxidisc curved (short model, used with extension)



General precautions:

- If you have long hair, ensure that it is properly tied back.
- Wear protective gloves
- Ensure suitable eye protection.
- Consider ear protection as excessive noise may damage hearing
- Consider mask to protect you from potential airborne particles.
- Make sure that you are familiar with dentistry techniques
- Be always aware of the potential hazards of treatment procedures.
- Coded 120V/220V apparatus should be used with GFCI protection only
- Keep materials, tools and hands dry while using electrical apparatus.
- Bulky clothing, rings, watches and jewelry are dangerous when performing equine dentistry
- Keep the HDE float clean and dry after use. Lubrication is not required.
- Use water for cleaning restrictively.

No daily maintenance - but service is recommended every six months. Please contact Swissvet for details at (877) 794 7735 or mail@swissvet.com

Preparation

Attachment of flex shaft to motor

Insert metal plate at the end of the flex shaft into the plastic slot of the motor. Secure the shaft by screwing the plastic nut onto the motor.



Feed the flex shaft through the extension
Not applicable for the long flexxidisc hand pieces (or long polyfloat)

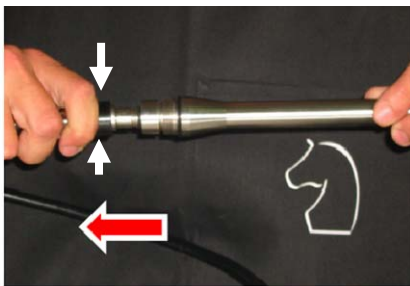

Attachment of the flex shaft to hand piece

A. classic connection

Pull back the black ring on the flex shaft before inserting the hand piece into the flex shaft



B. Quick release connection (all versions sold in the USA)

Simply insert the hand piece into the flex shaft

Make sure the shear pin (A) in the flex shaft (2) fits into the slot of the hand piece (1) when connecting the hand pieces with the flex shaft.

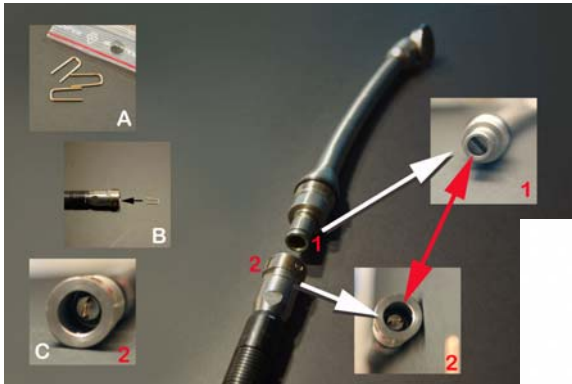

Shear pins

The function of the shear pins (A) is to prevent damage to the cable in the flex shaft. The shear pins are weaker than the cable and designed to fail first in the case of high torque conditions (usually due to biting on the burr).

If sufficiently deformed, the shear pins need to be replaced: remove the old pin, use a spare pin from supplied bag (A) and insert into flex shaft (B/C).

Use pliers for pin replacement or use the Quick Shear Pin device D (sold separately)



D



Extension

Once the flex shaft is connected to the hand piece, the extension is screwed tightly onto the hand piece.



The extension is not needed for the long flexidisc or polyfloat hand pieces.

Rotation of grinding head for flexidisc (or polyfloat)

- A. Old system: unscrew the sleeve for a few turns, enough to slightly pull (1) and rotate (2) the head into the desired position. Do not entirely remove sleeve. You can use your fingers to loosen, if too tight, you may use the supplied key #22 to unscrew. Retighten after rotation.
- B. New TWIST system: In a second, pull hard and turn the head of your curved Flexidisc or Polyfloat. The head should be rotated in one direction only.

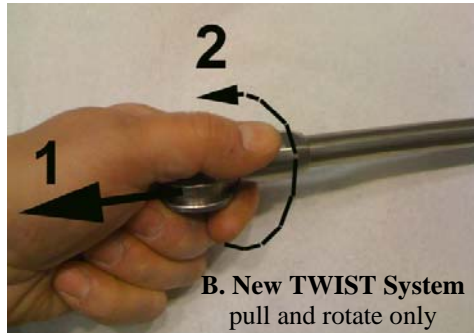

Hold the head tight with one hand and the shaft with the other hand. Pull the head away from the shaft, and rotate the head in 90 degrees increments until the desired position is reached.



Grinding burr replacement for the Polyfloat



Use the special key to fasten the base of the burr. Unscrew the burr with your hand and replace with new burr.

Do not hesitate to call Swissvet if you have any questions 877 794 7735



Maintenance and Service

Maintenance

- Daily maintenance or lubrication is not needed
- It is important to clean the grinding head as quickly as possible. Once dry, the dental debris is very difficult to remove.
- Although the grinding head is water resistant, water should be used restrictively to clean:
 - * Use a plastic or wire brush and water for cleaning.
 - * Do not run the grinding head when submersed in water.
 - * After cleaning, run the instrument to remove excess water .
 - * Keep the shaft dry with towel.
 - * Store flat in the HDE carrying case.



Service

- Service intervals depend on how heavily the instrument is used
- It is recommended to service the grinding head for Flexdisc and Polyfloat every six months.
- The first service is free of charge. This service will also determine how frequently the instrument should be serviced in the future.
- Service on other parts than the grinding head can be done by the user - or sent in to Swissvet.



Damage control

- H.D.E. instruments are durable and sturdy, however they are not designed for horses to bite on.
- Use the instruments with full mouth speculum only.
- Sudden stopping (ie biting on grinding head) puts stress on head and driving cable, and results in failure of shear pin

To increase the life span of the instrument and to avoid unexpected failure, is recommended to service every 6 months. The first service is free of charge.

A service plan or replacement instruments are available upon request. Please contact Swissvet for details (877) 794 7735



Distributed by
SWISSVET VETERINARY PRODUCTS
www.swissvet.com
(877) 794 7735

© 2010