



Horse Dental Equipment
HDE

USER MANUAL HDE BASIC UNIT



Distributed by
SWISSVET VETERINARY PRODUCTS
www.powerdentistry.com
877-794 7735

© 2008

1. Preparation

Attachment of flex shaft to motor

Insert metal plate at the end of the flex shaft into the plastic slot of the motor. Secure the shaft by screwing the plastic nut onto the motor.



Feed the flex shaft through the extension
(Not applicable for the short hand pieces)

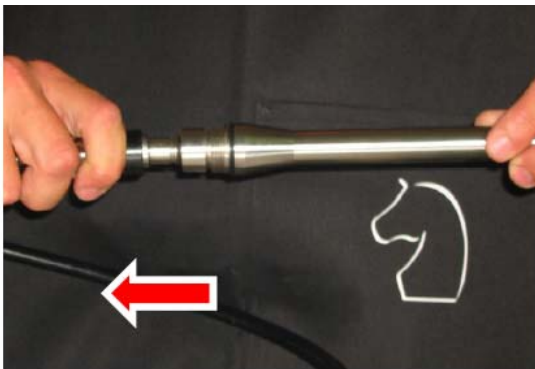

Attachment of the flex shaft to hand piece

a. classic connection

Pull back the black ring on the flex shaft before inserting the hand piece into the flex shaft



b. quick release connection

Simply insert the hand piece into the flex shaft

Make sure the shear pin (A) in the flex shaft (2) fits into the slot of the hand piece (1) when connecting the hand pieces with the flex shaft.

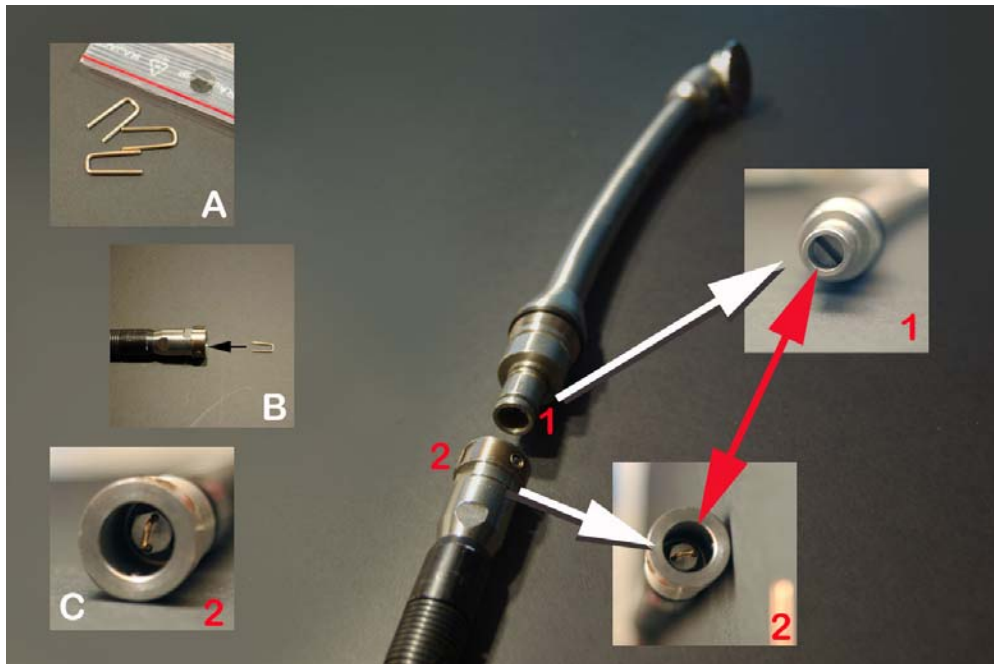

Shear pins

The function of the shear pins (A) is to prevent damage to the cable in the flex shaft. The shear pins are weaker than the cable and designed to fail first in the case of high torque conditions (usually due to biting on the burr).

If sufficiently deformed, the shear pins need to be replaced: remove the old pin, use a spare pin from supplied bag (A) and insert into flex shaft (B/C)



Extension

Once the flex shaft is connected to the hand piece, the extension is screwed tightly onto the hand piece. This is only applicable with the long hand pieces. The short hand pieces are used without extension.

2. Application

A. Mandibular Hand Piece (use with or without extension)



The 2 protective panes guide the hand piece along the tooth (see arrow).

To work on the 11s, use the flat end of the guard to push the soft tissue and grind only the tooth.



Warning : Keep the handpiece moving along the arcade; do not rest the burr on one tooth as we encourage you not to take off too much tooth.

B. Universal and Maxillary Hand Piece (use with or without extension)

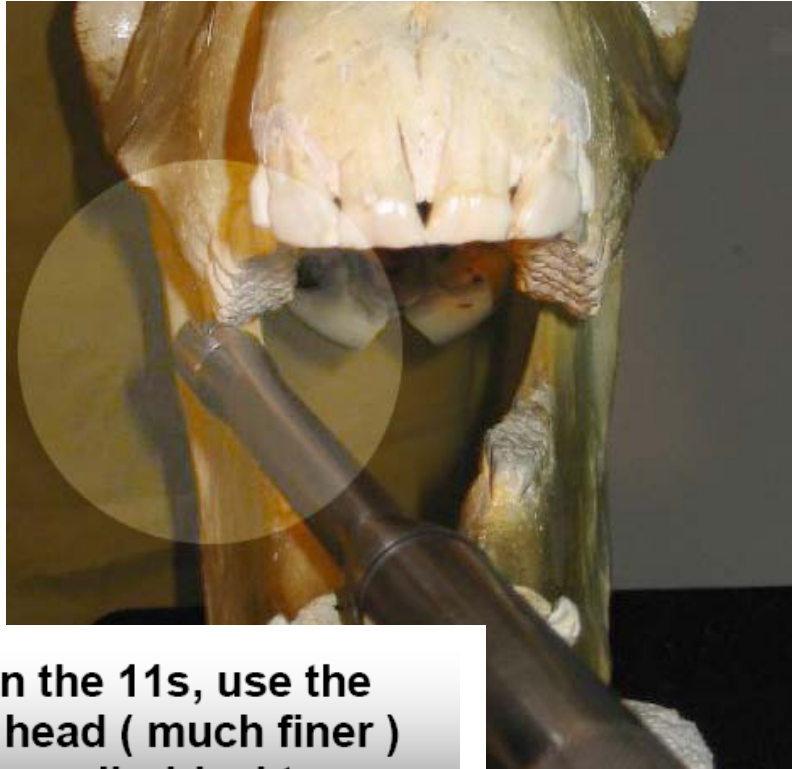

To work on the 11s, use the top of the head (much finer) and use the cylindrical to finish the work.



To do a bit-seat, work from the opposite side of the mouth (for example use handpiece in left hand to work on 206). Use your thumb to guide the hand piece (see enclosed picture).



C. Short Hand Pieces without extension

Use the Ball Hand Piece or the Profiling Hand Piece for bit seat formation:



Achieve a bit-seat on the 306 & 406 without any difficulties.

This hand piece is to be used without extension.



Work on incisor is easily done with the profiling hand piece, the universal hand piece without extension and best with the grinding wheel.

3. Maintenance



To clean the handpieces, run them in clean water for a few seconds at high speed



Dry them with a towel.



Use only a nylon brush to clean the diamond head.



Position the hand pieces upright (head downwards) to keep water out of the bearings