

Quick Start Manual

Dr. Fritz Dental Stick

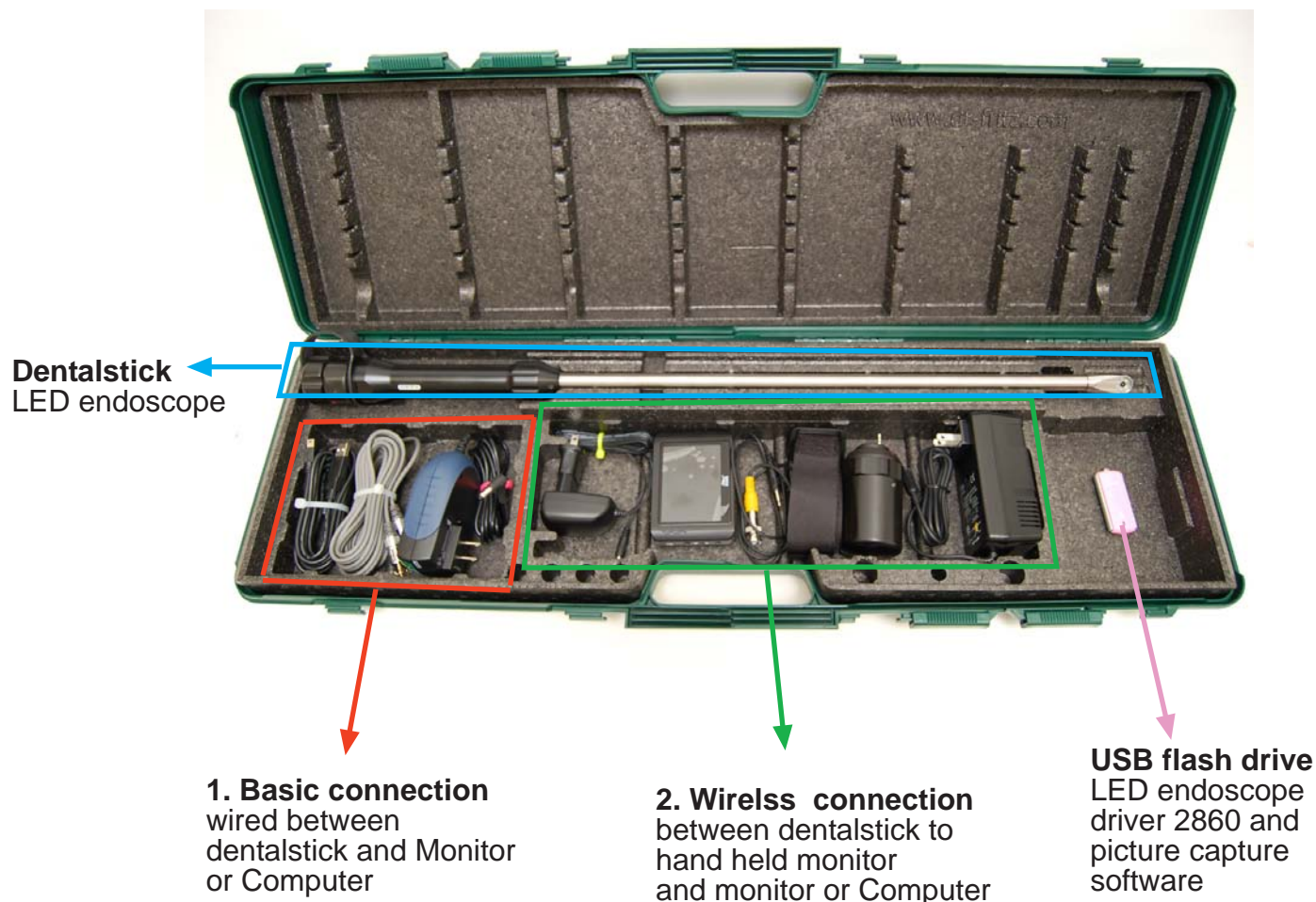

Dentalstick
LED endoscope

1. Basic connection
wired between
dentalstick and Monitor
or Computer

2. Wireless connection
between dentalstick to
hand held monitor
and monitor or Computer

USB flash drive
LED endoscope
driver 2860 and
picture capture
software

Quick Start

The Dr. Fritz LED dental endoscope (aka Dentalstick) is easy to use. However we strongly recommend reading the user manual carefully. This quick start manual will help you only to get started quickly.

IMPORTANT

you need a special driver installed on your computer for direct connection of the endoscope to a laptop or desktop computer. Do not connect the endoscope before installing the driver.

The USB flash drive contains the driver and the video capture software (AMCAP) and a media player (VLC media player). Please copy the entire content of the USB flash drive to the computer and install the dental stick driver 2860 first.

Please do not hesitate to contact Swissvet if you have any questions. We are more than happy to assist you!

Thank you for your business, we appreciate it very much.

Quick Start Manual

Wired Connection



Power supply 12V
Connects to the Y-cable
and provides power to
the LED endoscope



Monitor connection
Connects the Y-cable
to an analog monitor
with a video plug or an
antenna adaptor
(fits onto the plug)

USB cable
Connects LED endoscope
to a computer. Requires
driver, **DO NOT CONNECT
UNLESS THE DRIVER IS
INSTALLED.**



USB flash drive
The USB flash drive contains the endoscope camera driver 2860, the video capture software (AMCap) and a media player (VLC media player). Please copy the entire content of the USB flash drive to the computer and install the dental stick driver 2860 first.

The AMCap and VLC software can be found as share ware online, in case you have problems installing them to your particular computer system

Quick Start Manual Wireless Connection

Wireless module

Align the two red dots and click module onto the dentalstick. Turn on the switch and the module sends a wireless signal to the small hand held monitor.

Read the separate manual for the monitor for more information.



USB cable

connects the hand held monitor to a computer does not require software, should connect automatically



Micro SD memory card for monitor
with USB adapter (left) and full size SD adaptor for compatible devices

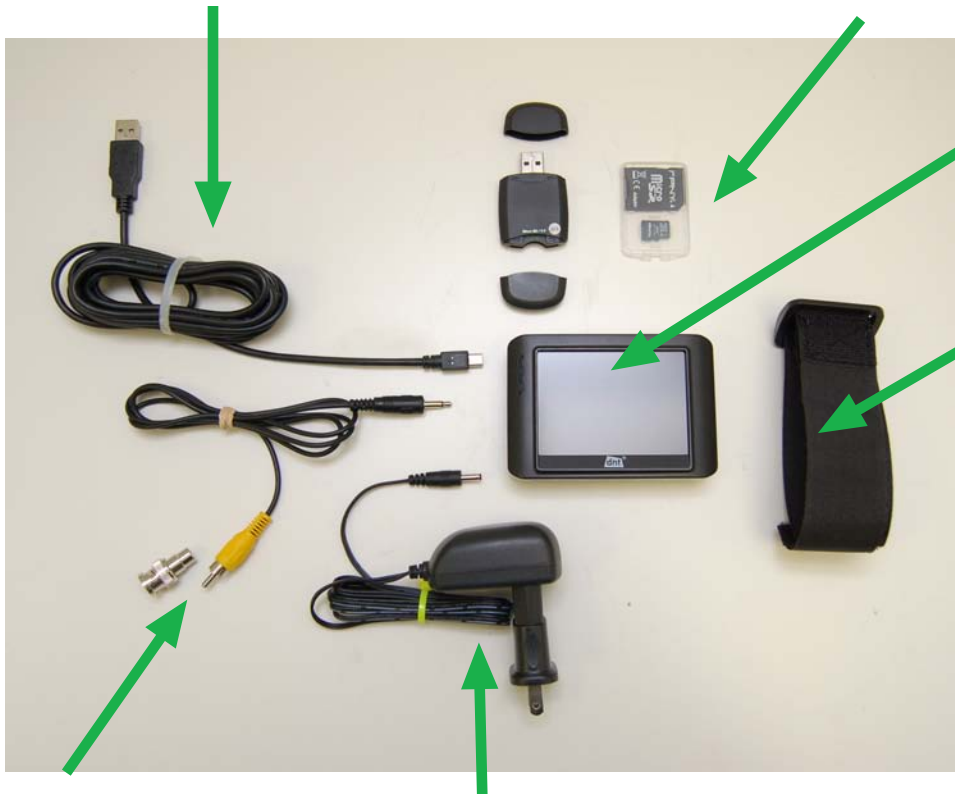

TFT wireless monitor
attaches via Velcro to the Arm strap. See separate manual for more information

Arm strap for monitor
attaches via Velcro to the hand held monitor

Monitor connection

Connects the hand held small monitor to an analog monitor with a video plug or an antenna adaptor (fits onto the plug)

Charger for the monitor 5V
Connects to the monitor



Charger 8.4V for wireless module
Make sure the Li-Ion battery is fully charged. May take up to 1hr. The green light on the module indicates a fully charged battery.